

LICENSABLE ACTIVITIES:
 SALE OR SUPPLY OF ALCOHOL
 CONSUMPTION OF ALCOHOL AND
 PLAYING OF RECORDED MUSIC

- LEGEND:**
- FIRE ALARM PANEL
 - BELL
 - BREAK GLASS UNIT
 - EMERGENCY BLADEHEAD LUMINAIRE SURFACE MOUNTED
 - EMERGENCY EXIT SIGN (DIRECTIONAL)
 - FIRE DOOR
 - CARBON DIOXIDE EXTINGUISHER
 - FOAM EXTINGUISHER
 - SMOKE DETECTOR
 - HEAT DETECTOR
- Area for all licensed premises for consumption of alcohol

- ASSEMBLY POINT: BASINGSTOKE ROAD
- ASSEMBLY POINT: PARKING AREA
- ESCAPE ROUTE



PARKING AREA

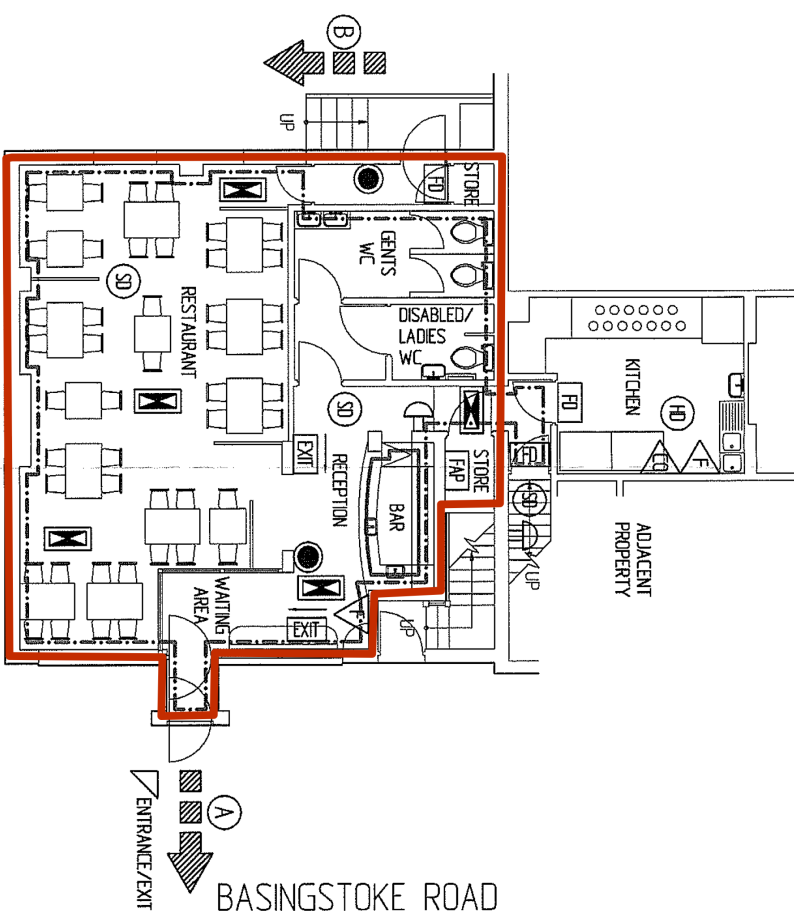

BASINGSTOKE ROAD

GENERAL NOTES:

These plans are accurate to the visible information available to the surveyor on the date of survey.

Escape routes, emergency lighting, signage, fire and safety equipment, etc. have been noted in the locations inspected on that day.

Saficad Ltd is not liable for the accuracy, content or non-compliance with recommendations made in any assessment (fire, risk, hazard, etc.) made by others of the premises or for information conveyed on this drawing pertaining to those assessments.

In no event will Saficad Ltd be liable for direct, indirect, special, incidental or consequential damages (including but not limited to economic loss, such as loss of profits, loss of use of premises, loss of business or business interruption, loss of revenue, loss of good will or loss of anticipated savings) arising out of the use, or inability to use, or the failure of compliance of this plan.

Saficad Ltd is limited in its liability in respect of the plans provided for submission to rectification / amendment of this plan to the requirements of the council only.

The base architecture for this building has been produced by vectorizing an existing print. Verification of scale was achieved by overall dimensions only.

This property was surveyed on 01/08/05.

saficad ltd
 5, Braden Way, Purley-on-Thames,
 Reading, Berkshire, RG8 8BS
 Telephone/Fax: (0186) 944-3264
 Mobile: 077-6117-4008
 Email: keran@thames@saficad.co.uk
 engineering and administrative
 support services

CLIENT:
 MAH'S, SPENCERS WOOD
 BASINGSTOKE ROAD
 SPENCERS WOOD, RG7 1AE

PROJECT TITLE:
 LICENCE SUBMISSION
 PLAN

DRAWING TITLE:
 LICENSABLE ACTIVITIES
 GROUND FLOOR PLAN

SCALE:
 1:100
ARCHITECT/ENGINEER: K.J.R.
 For Reprographic Purposes This Line Is
 To Equal 50 mm On The Original Drawing

DRAWN	CHKD	DATE
DKR	DKR	03/08/05
CHECKED	RYR	DATE: 03/08/05
AUTHORISED	K.J.R.	DATE: 03/08/05

PROJECT ID:	REV:
50750/3	0
DRAWING NO:	LS/01

This page is intentionally left blank